



# INSTALLATION OF LANDING ENTRANCE DOOR RESTRICTOR ASSEMBLY



ONE WORKER REQUIRED



18MM/ADJUSTABLE WRENCH, STANDARD HAMMER

**STEP 5:** ATTACH THE DOOR RESTRICTOR MAGNET, USE THE PART'S PROVIDED HARDWARE(NOT SHOWN IN LIST). THE RESTRICTOR MAGNET IS TO BE INSTALLED ON THE STRIKE(CLOSING) SIDE.

THE DOOR RESTRICTOR IS NOT TYPICALLY USED IN RESIDENTIAL APPLICATIONS

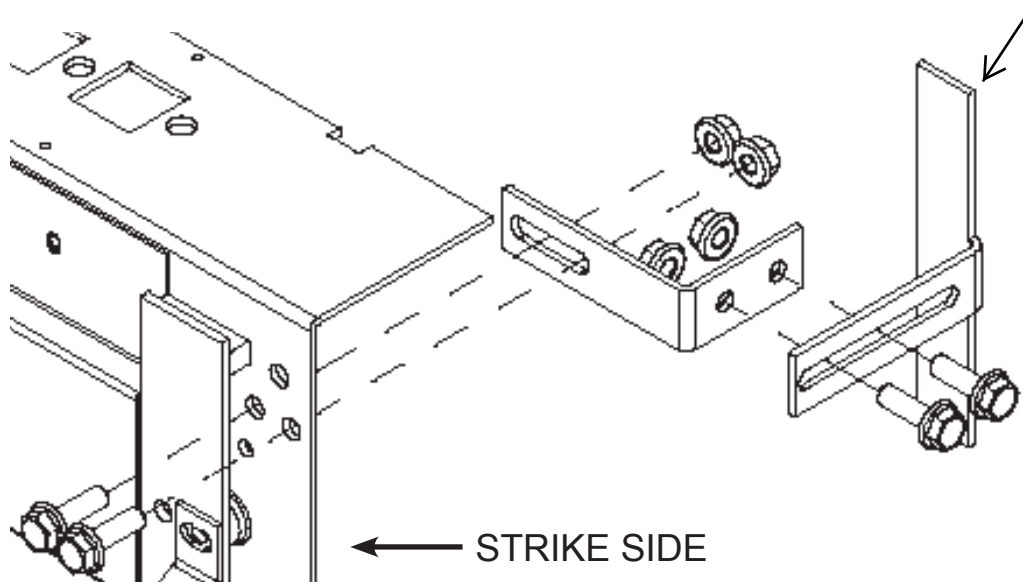

# INSTALLATION OF LANDING ENTRANCE LANDING MECHANISM



ONE WORKER REQUIRED



PLIERS

**STEP 6:** TO INSTALL THE DOORS FOLLOW THE INSTRUCTIONS ON PAGES 5.06, 5.07 AND 5.08. ENSURE DOORS RUN FREELY ON LANDING SILL.

**STEP 7:** THE FRAMLESS LANDING MECHANISM COMES WITH THE TENISON SPRING BUILT INTO THE MECHANISM ASSEMBLY. THE DOORS SHOULD BE ABLE TO CLOSE BY THEMSELVES IN CASE OF POWER FAILURE. IF MORE TENSION IS NEEDED, SHORTEN THE SPRING AND REATTACH. BE SURE TO DO THIS WHEN THE DOORS ARE CLOSED.

## DOORS CLOSED

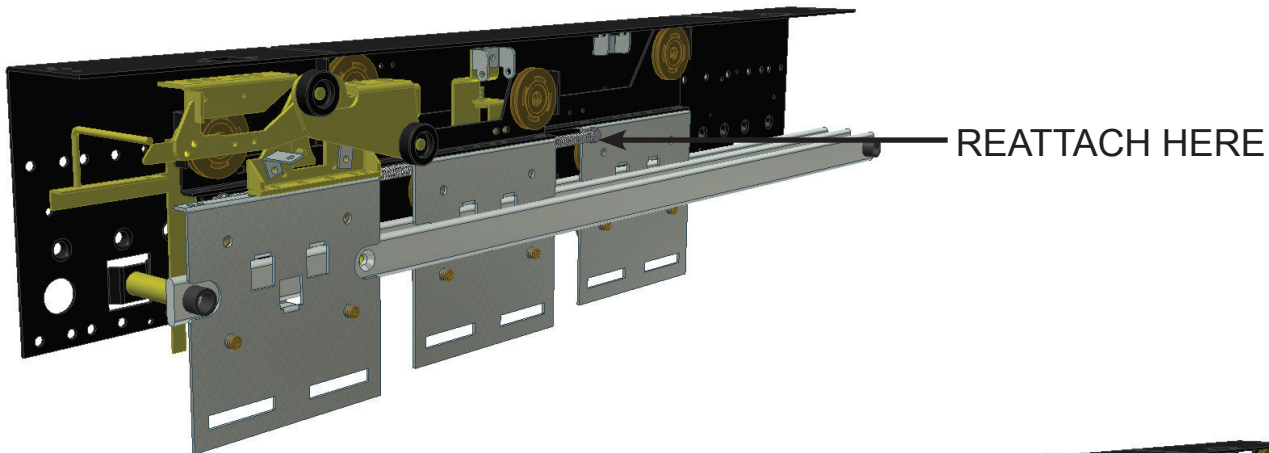

## DOORS OPEN

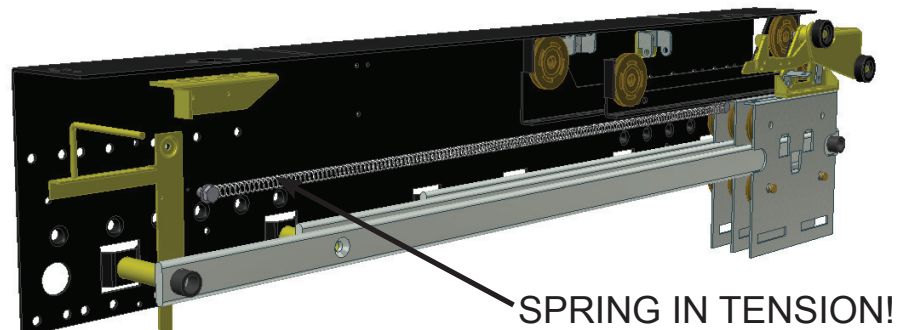

# INSTALLATION OF LANDING ENTRANCE TOE GUARD



ONE WORKER REQUIRED



3mm ALLEN KEY, 8mm WRENCH

**STEP 8:** MOUNT TOE GUARD TO SILL SUPPORT USING HARDWARE SHOWN BELOW.

AT THIS POINT, THE ENTRANCE SHOULD BE FULLY FUNCTIONAL WITH THE CAB OPERATOR, ALL DOOR PANELS SHOULD RUN SMOOTH, AND WHEN FULLY OPEN ALL PANELS SHOULD BE FLUSH TO EACH OTHER.

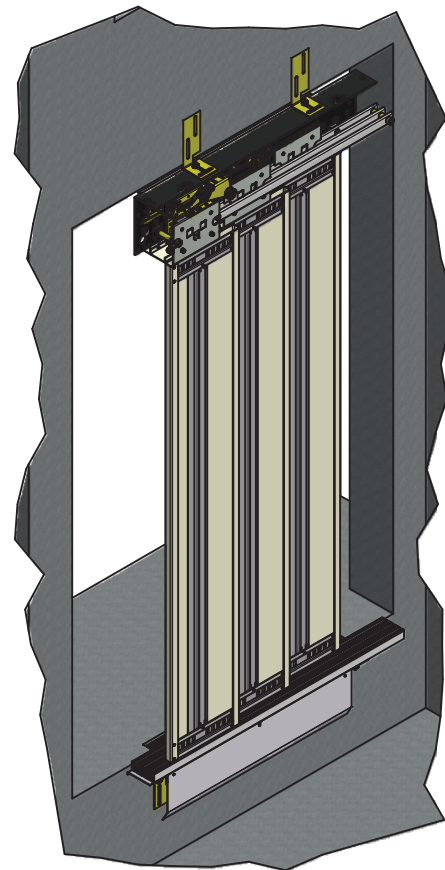
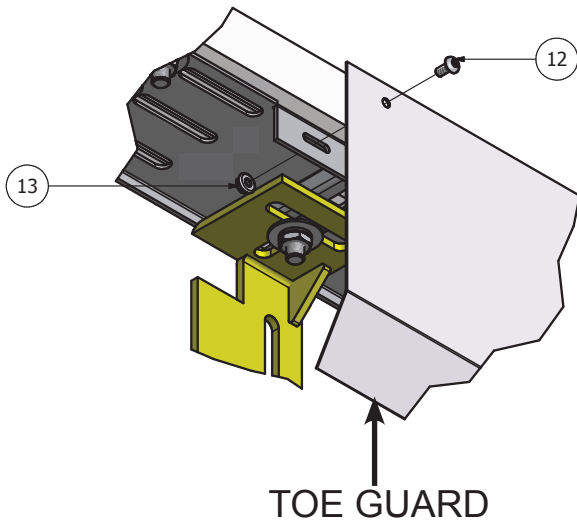

# INSTALLATION OF LANDING ENTRANCE CUSTOM FRAME CONSTRUCTION



ONE WORKER REQUIRED



TOOLS OF CARPENTERS CHOICE

**STEP 1:** CONSTRUCT FRAME AS SHOWN. THE TYPE OF MATERIAL, MATERIAL THICKNESS, AND WIDTH OF RETURN POST ARE OF CUSTOMERS CHOICE AND SHOULD BE CONSTRUCTED TO MATCH THE HOME DECOR.

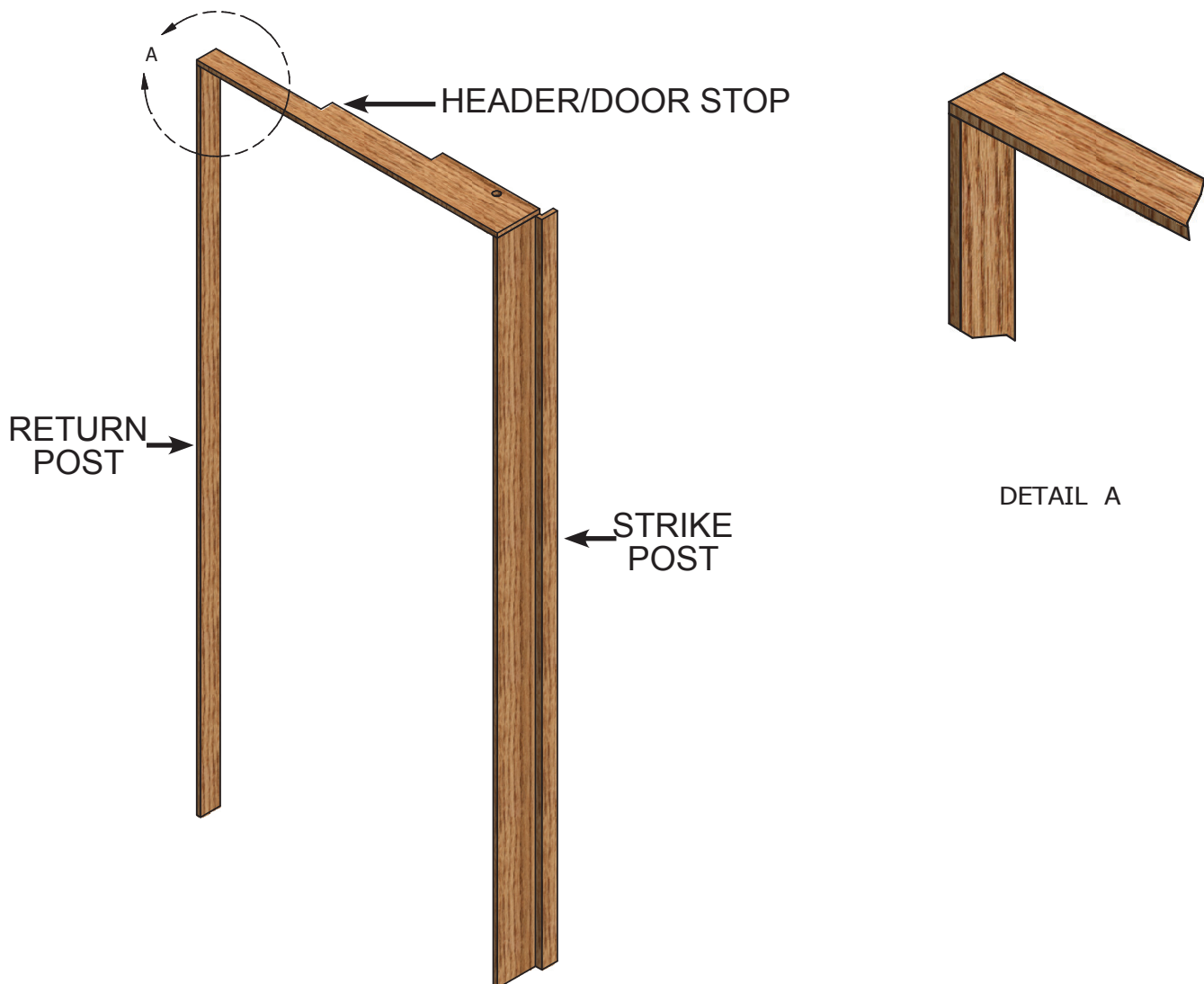



# INSTALLATION OF LANDING ENTRANCE CUSTOM FRAME INSTALLATION



ONE WORKER REQUIRED



TOOLS OF CARPENTERS CHOICE

**STEP 2:** WITH DOOR PANELS INSTALLED AND ALIGNED, PLACE AND SECURE THE LANDING FRAME. ENSURE THERE IS A  $5(3/16)$ " RUNNING CLEARANCE BETWEEN THE DOORS AND RETURN POST. ONCE THE DOORS ARE FULLY OPEN THE DOOR EDGES SHOULD BE FLUSH WITH THE RETURN POST. CAREFULLY OPEN AND CLOSE THE DOORS MAKING SURE THERE IS NO INTERFERENCE BETWEEN ANY MOVING PARTS.

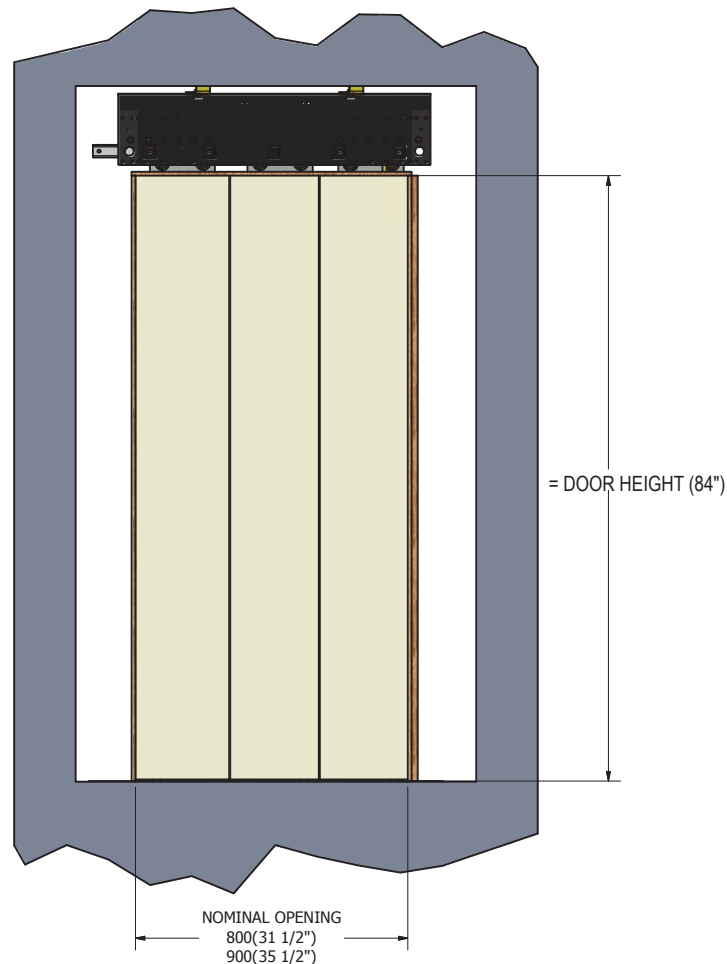

# INSTALLATION OF LANDING ENTRANCE KEY LOCK INSTALLATION



ONE WORKER REQUIRED



NO TOOLS REQUIRED

**STEP 3:** INSTALL THE KEY MECHANISM AS SHOWN. ENSURE ARM IS PLACED WITHIN THE HORIZONTAL SLOT IN THE BRACKET. TEST AND ENSURE IT IS FULLY OPERATIONAL.

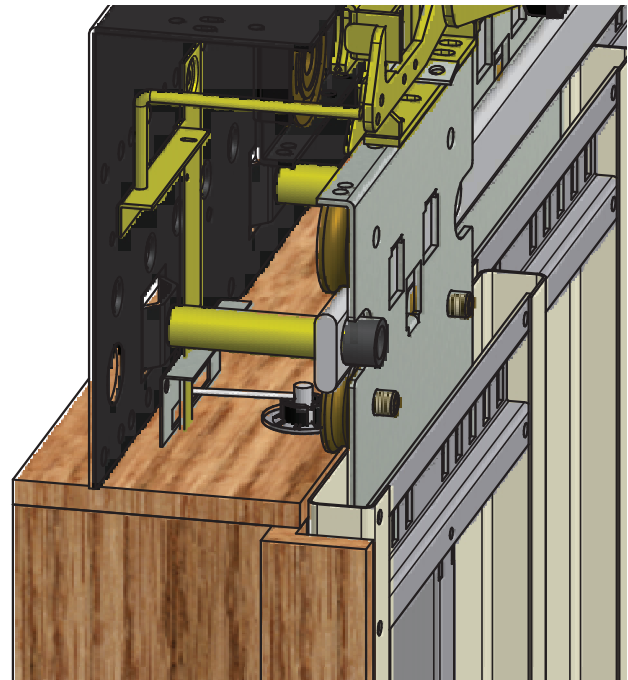
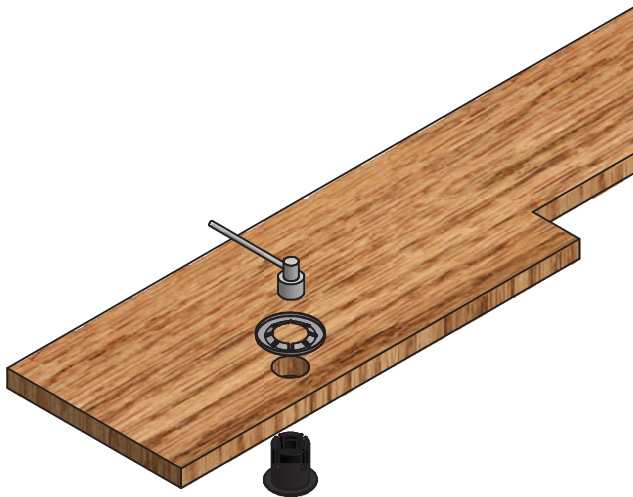

THE LANDING ENTRANCE IS NOW COMPLETE, THE CARPENTER DOING THE WORK CAN NOW ADD TRIM ON THE OUTSIDE TO MATCH THE REST OF THE HOME DECOR.